

2019 METC CONFERENCE EXHIBITOR INFORMATION

As an METC Conference Exhibitor, your organization will reach a large cross-section of school staff, teachers, principals, technology coordinators and educational leaders.

Exhibitor Registration is online only. Standard Single and Standard Double Exhibit spaces are available and will be assigned by METC / EdPlus Staff. EducationPlus reserves the right to make any adjustments necessary throughout planning.

Standard Single Booth - \$900 (10x10, 100 Square Feet)
Standard Double Booth - \$1,450 (10x20, 200 Square Feet)

Included with each Exhibit Booth is the following:

- Each 10' x '10 booth will be set with 8' high back wall drapery and 3' high side rail draperies
- One 7" x 44" Exhibitor ID sign
- One 8' draped table and **two** side chairs
- Security guard services
- 10 Amp electrical outlet. Additional electrical service is available for purchase.
- WiFi access
- A listing in the exhibitor directory on the conference website and METC Mobile App
- Breakfast and lunch on all conference exhibitor days, **two** representatives for a single booth, **four** representatives for a double booth.
- Breakfast and lunch may be purchased for additional booth representatives for a \$50 fee per person.

Additional Services Available for Purchase

Hard wire internet connectivity and additional electrical services are available for an additional cost through the St. Charles Convention Center. Please contact the exhibitor services department at 636.669.3011 or exhibitorsvs@StCharlesConventionCenter.com.

Carpet is not provided within your rented exhibit space. Rental carpet is available through Paramount Convention Services. Visit the Paramount website at www.paramountcs.com to view additional amenities for your booth. Our #METC19 Conference Paramount contact is Katie Shashack at Katie@paramountcs.com or 800.883.6578.

NEW #METC19 CONFERENCE EXHIBITOR HALL MAP

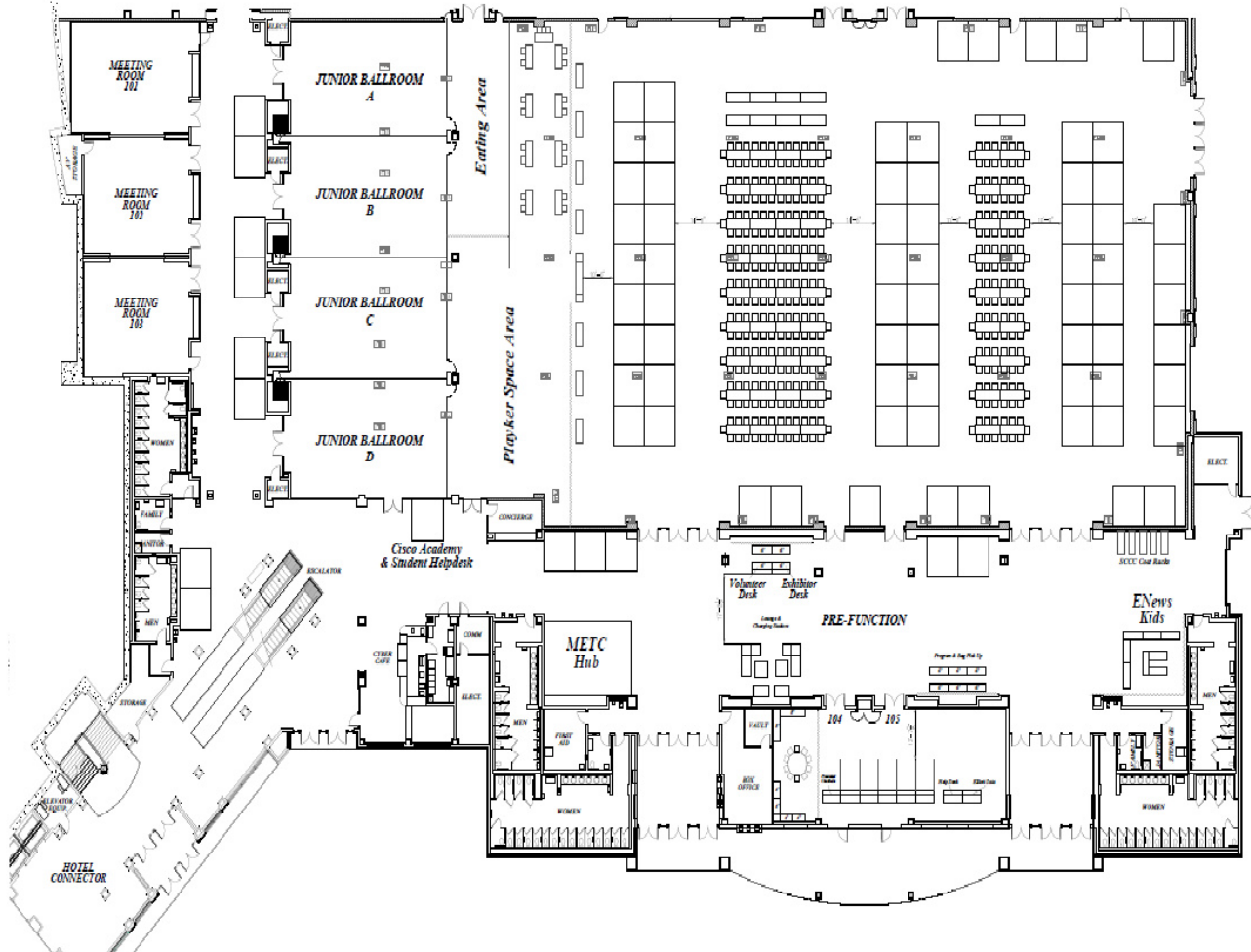

FEBRUARY 11 – 13, 2019 | ST. CHARLES CONVENTION CENTER | #METC19

GENERAL CONFERENCE EXHIBITOR INFORMATION

Location: The St. Charles Convention Center in the North & South Exhibit Halls
One Convention Center Plaza, St. Charles, MO

Exhibit Hours:

- Move-In: Monday, February 11, 2019 – 12:30pm – 4:30pm
- Exhibit Hall Hours:
 - Tuesday, February 12, 2019 – 8:30 a.m. - 4:30 p.m.
 - Wednesday, February 13, 2019 – 8:30am – 1:30pm
- Move-Out: Wednesday, February 13, 2019 – 1:30pm – 4:30pm

Booth Set-up and Dismantle:

- Set up in the Exhibit Hall is open on Monday, February 11, 2019 from 12:30 p.m. to 4:30 p.m.
- The Exhibit Hall opens Tuesday, February 12 at 8:30 am. We request at least **one** company representative be present at your booth during all exhibit hours.
- Dismantling may begin at 1:30 pm on Wednesday, February 13, 2019 and continues until 4:30 pm.

Selling from the Exhibit Hall Floor

Exhibitors may sell items during the conference exhibit hall hours. Neither EducationPlus nor the St. Charles Convention Center are responsible for any losses or liabilities that occur due to this activity.

Lead Retrieval

Lead retrieval services will be provided through METC's registration provider: Cvent. Following registration, enrollment information will be sent to Exhibitors.

Conference General Contractor

Once you have registered online to be an METC conference exhibitor, you will be contacted by Paramount Convention Services with the exhibitor kit information. Our #METC19 Conference contact is Katie Shashack at Paramount Convention Services, Inc. at Katie@paramountcs.com or 800.883.6578.

Parking

Parking is free at the St. Charles Convention Center and for guests at the Embassy Suites. Overflow parking is in the northwest corner next door to the convention center.

Cancellation Policy

Cancellation requests must be made in writing to LaDonna Henderson at lhenderson@edplus.org. Cancellations made by January 25, 2019 will incur a 20% cancellation fee. Cancellations received after January 25, 2019 are not eligible for a refund. METC Conference will not be cancelled due to inclement weather. No-shows will be billed in full.

Hotel Reservations

The following hotels are near the St. Charles Convention Center.

St. Charles Hotels:

Ask for the METC rate when contacting these hotels.

Embassy Suites Hotel (Connects to the Convention Center)

Two Convention Center Plaza

St. Charles, MO 63303

636.946.5544

Daily Rate: \$152

Group Code: MET

Drury Hotels

380 Mulholland Drive

St. Charles, MO 63303

636.724.5772

Daily Rate: \$109

Group Code: 2350877

Additional Hotels nearby:

Best Western Hotel

125 South Fifth Street

St. Charles, MO 63303

636.946.6936

Fairfield Inn & Suites by Marriot St. Louis St. Charles

801 Veterans Memorial Parkway

St. Charles, MO 63303

636.946.1900

True by Hilton St. Charles St. Louis

333 Camelback Road

St. Charles, MO 63303

636.669.2500

About EducationPlus:

Founded in 1928, EducationPlus is an educational service agency that provides technology training, staff development, cooperative purchasing, legislative advocacy and financial services to public school districts in the Greater St. Louis Metropolitan Area. EducationPlus serves over 500 schools and more than 300,000 students – or nearly one-third of Missouri's K-12 students. EducationPlus' mission is to enhance educational opportunities for all students by providing exemplary service to member districts.

2019 METC CONFERENCE SPONSOR INFORMATION

Be a Conference sponsor! Support the conference by being a #METC19 Conference sponsor. For additional information, contact Dr. Jennifer Tiller at jtiller@edplus.org.

<p>Specialty Luncheon Speaker 6 @ \$3,500</p>	<p>Receive recognition during one of the six specialty luncheons and have the opportunity to briefly speak at the start of the event. Signage indicating your company as the speaker sponsor will be placed in the banquet room.</p>
<p>Connections Lounge \$3,500</p>	<p>Sponsor the lounge for attendees to connect, collaborate and charge their electronics (or donate lounge furniture). Signage indicating your company as the sponsor will be placed in the charging lounge.</p>
<p>Speaker Appreciation Dinner \$2,500</p>	<p>Sponsor the opening night Appreciation Dinner for the Keynote, Featured and Spotlight speakers and have an opportunity to speak with this group of key EdTech leaders and EdPlus leadership staff. Signage indicating your company as the sponsor will be placed in the Boardroom.</p>
<p>Lanyard \$2,500</p>	<p>Your company name will be printed alongside the METC logo on all attendee, presenter and exhibitor lanyards. Approximately 2,000 lanyards distributed.</p>
<p>Student Support 3 @ \$1,500</p>	<p>Sponsor a team of students to support the IT Help Desk, eNews Bureau, Innovation SHOWcase or Playkerspace that provides a real-world learning experience. In addition to signage near the designated student area, your company logo will be on the student volunteer t-shirts.</p>
<p>Breakfast 3 @ \$1,500</p>	<p>Sponsor the morning breakfast and have an opportunity to greet and interact with attendees during this morning hour. Signage indicated your company as the sponsor will be placed in the breakfast area</p>
<p>Afternoon Break 2 @ \$500</p>	<p>Sponsor the afternoon beverage and snack break for one of the conference days. The afternoon break is highly visible to attendees. A sign indicating your company as the sponsor will be placed at each food break station.</p>